

AERODROME CHART - TENGAH

01°23'15.40"N 103°42'29.80"E

RSAF TENGAH

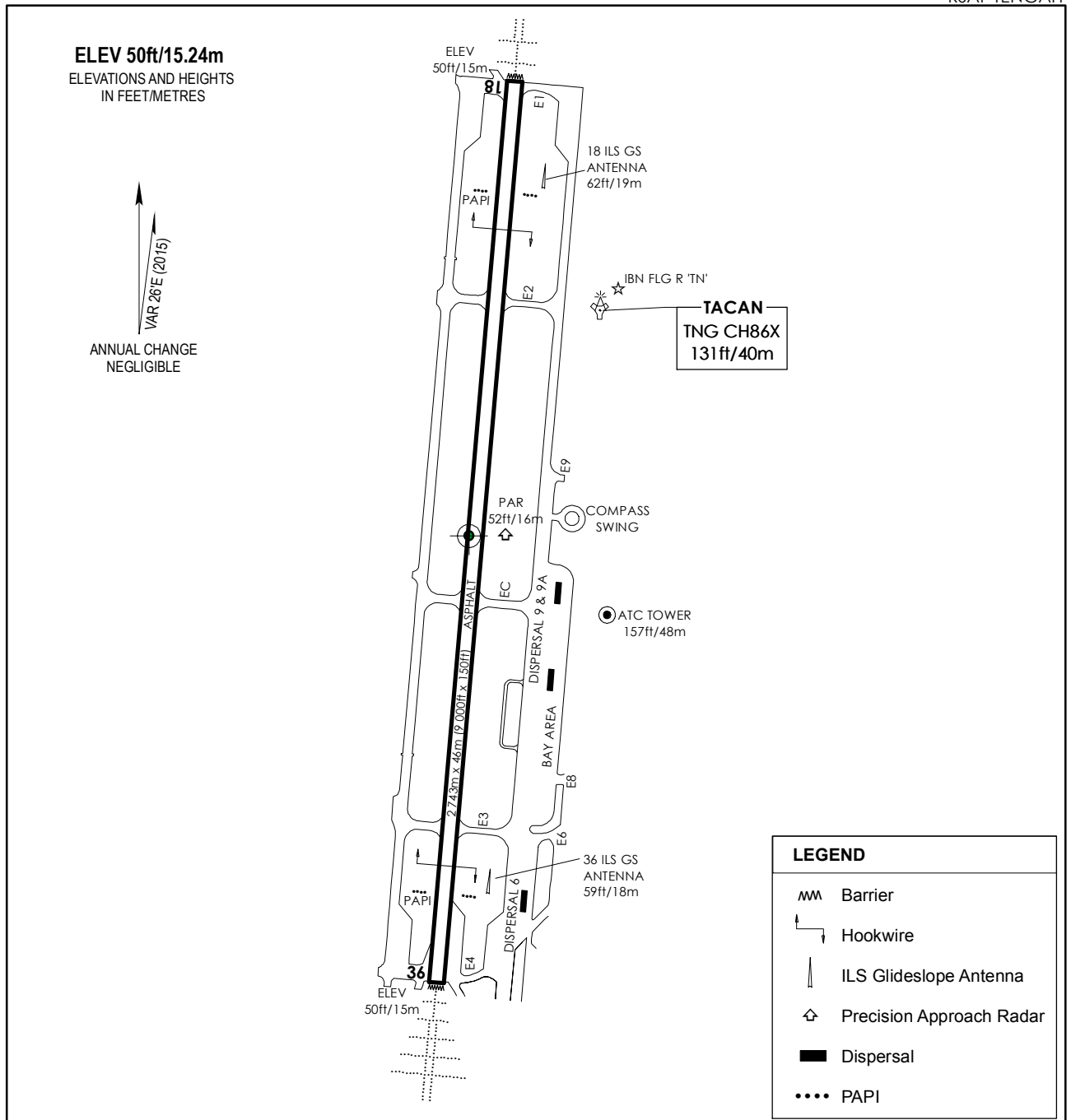

AERODROME LIGHTING	
APPROACH LIGHTING :	
Approach RWY 18	High intensity white centre line and 2 bars. Superimposed omni-directional RED 'T'.
Approach RWY 36	High intensity white centre line and 5 bars. Superimposed omni-directional RED 'T'.
RWY 18/36	Sequenced flashing lights.
RUNWAY LIGHTING :	
RWY 18/36	High intensity omni-directional white edge lights. Green THR lights. Red RWY end lights.
Ident Beacon	TN coding in RED.
Taxiway	Blue edge lights. Green centreline lights.
Dispersal	Blue edge lights. Floodlights
Illuminated distance to run marker boards.	

CAUTION	
1)	RWY lights 0.3m out from RWY edge.
2)	All circuits east of aerodrome within 3NM up to 1 500ft (457m).
3)	RWY 36 - Right hand circuit.
4)	Two masts, height 6m, located on the eastern shoulders : a) Runway 36 - 233m from threshold, 100m from runway centre line. b) Runway 18 - 273m from threshold, 100m from runway centre line.
Obstacles lit at night. Helicopters operating in Helizone are to exercise extreme caution.	